

Building 2 / Stage 4

Main Floor

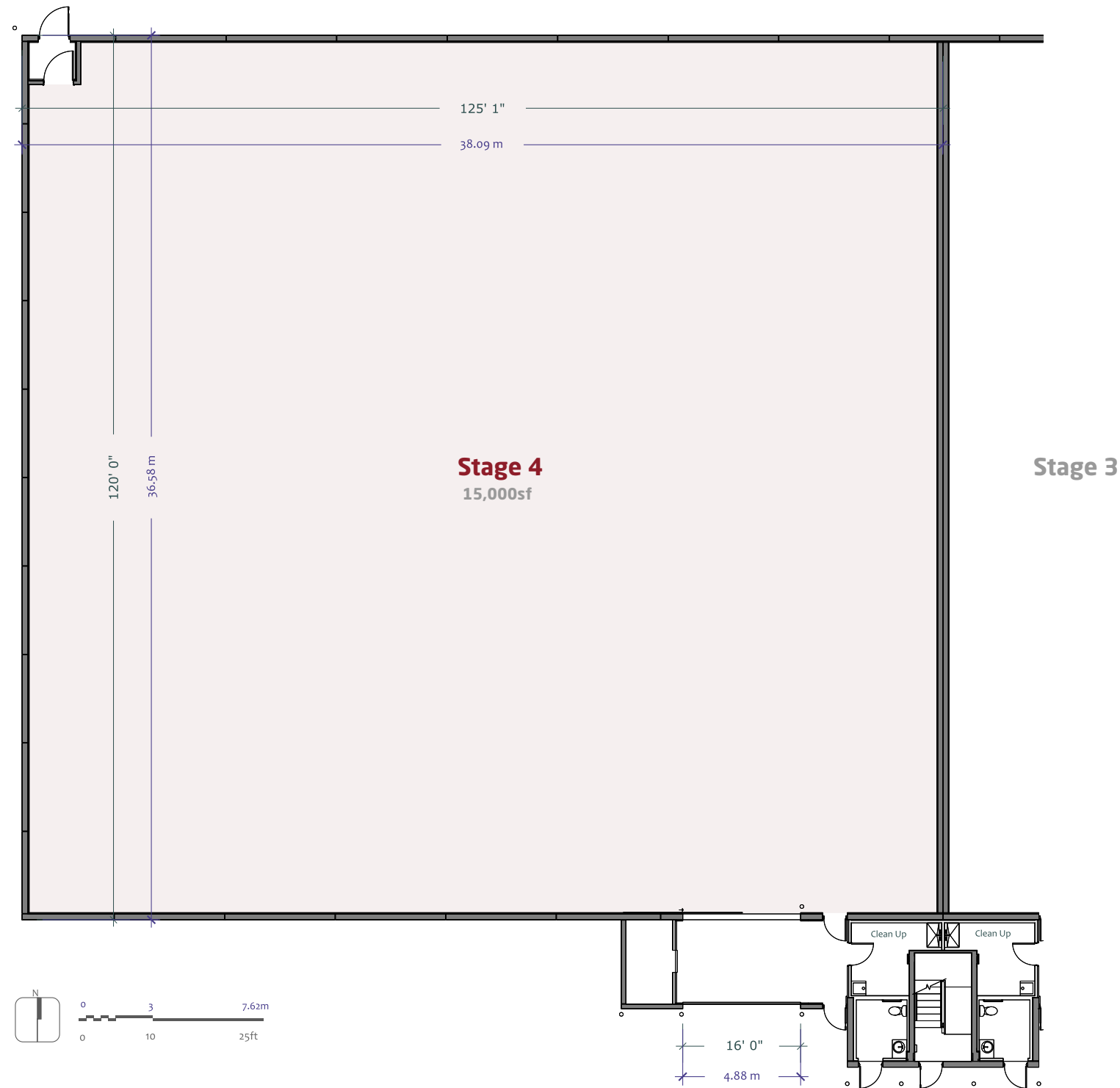

Site Legend



Features

- 15,000sf [1394ms]
- 120' x 125' x 40' UST
- Roof trusses to 16,000 lb each
- Laser flat concrete floors with floor drain and water supply
- Separate dimmer room
- 4 400 amp switches in stage
- LED lighting & stumble lights in stage for safe exiting
- Air conditioned & heating by electricity



Bridge Studios is proud to commit to making our Griffiths Studios location a 100% Fossil Fuel Free Facility.



info@bridgestudios.com

1-604-482-2000

Part of the Bridge Studios Family