

Stages 1-3

Main Floor

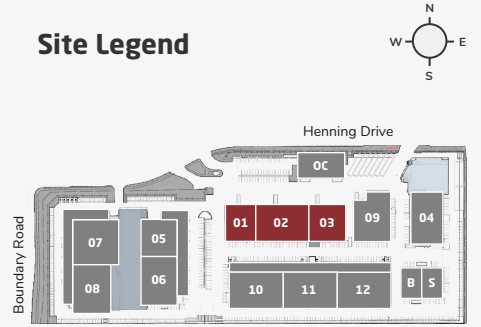
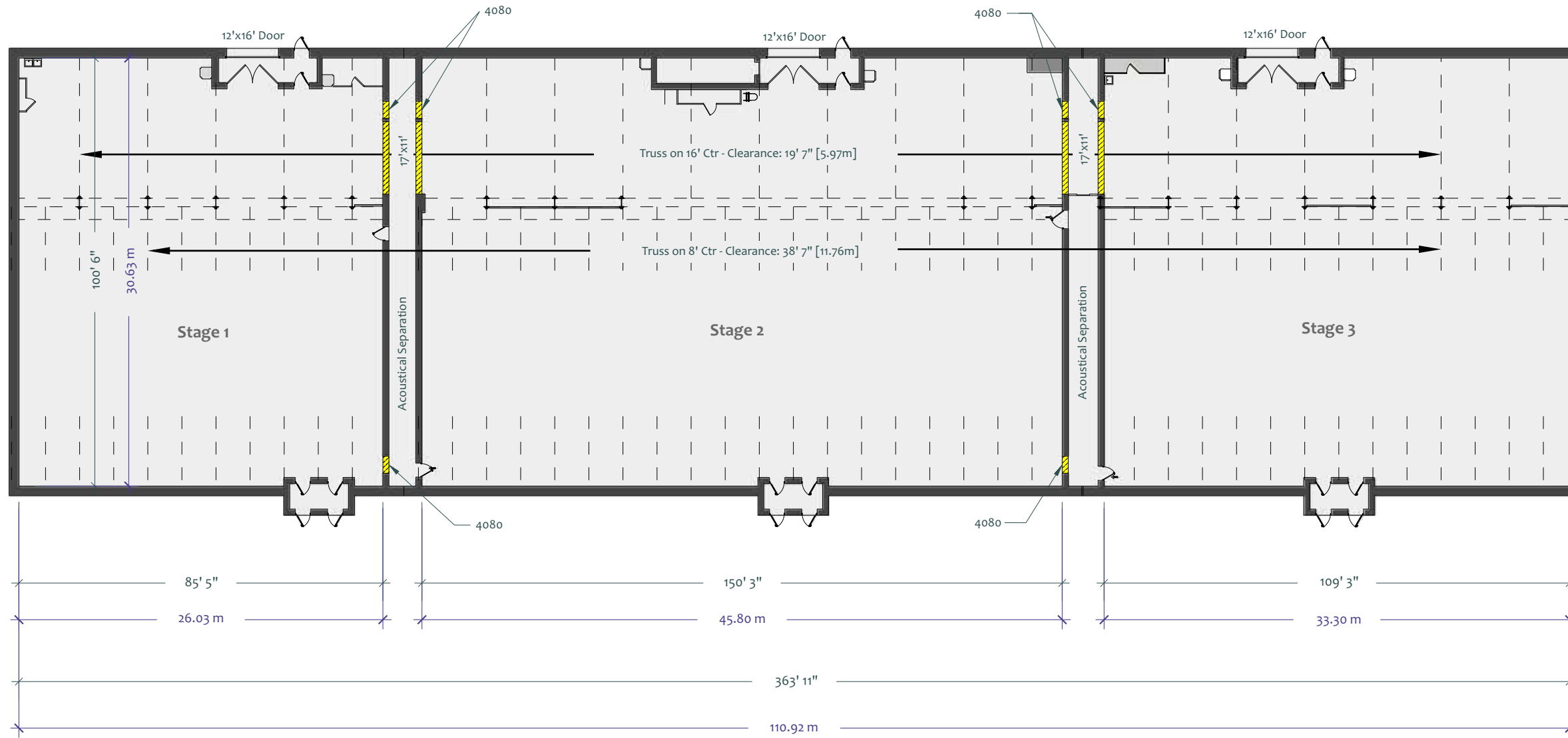

Stage 1 Features

- 8,500sf [790ms]
- Soundproof
- Elephant Doors
- 1800amps 120/208v
- GRID = 7,500 Total Lbs./Truss
- Reverb. Time = 1 sec @ 500hz
- Air conditioned

Stage 2 Features

- 15,000sf [1,390ms]
- Soundproof
- Elephant Doors
- 1800amps 120/208v
- GRID = 7,500 Total Lbs./Truss
- Reverb. Time = 1 sec @ 500hz

Stage 3 Features

- 11,000sf [1,020ms]
- Soundproof
- Elephant Doors
- 1800amps 120/208v
- GRID = 7,500 Total Lbs./Truss
- Reverb. Time = 1 sec @ 500hz
- Air conditioned

Optional Removable Wall Sections



info@bridgestudios.com

1-604-482-2000

Part of the Bridge Studios Group